

Planzeichnung M= 1:500

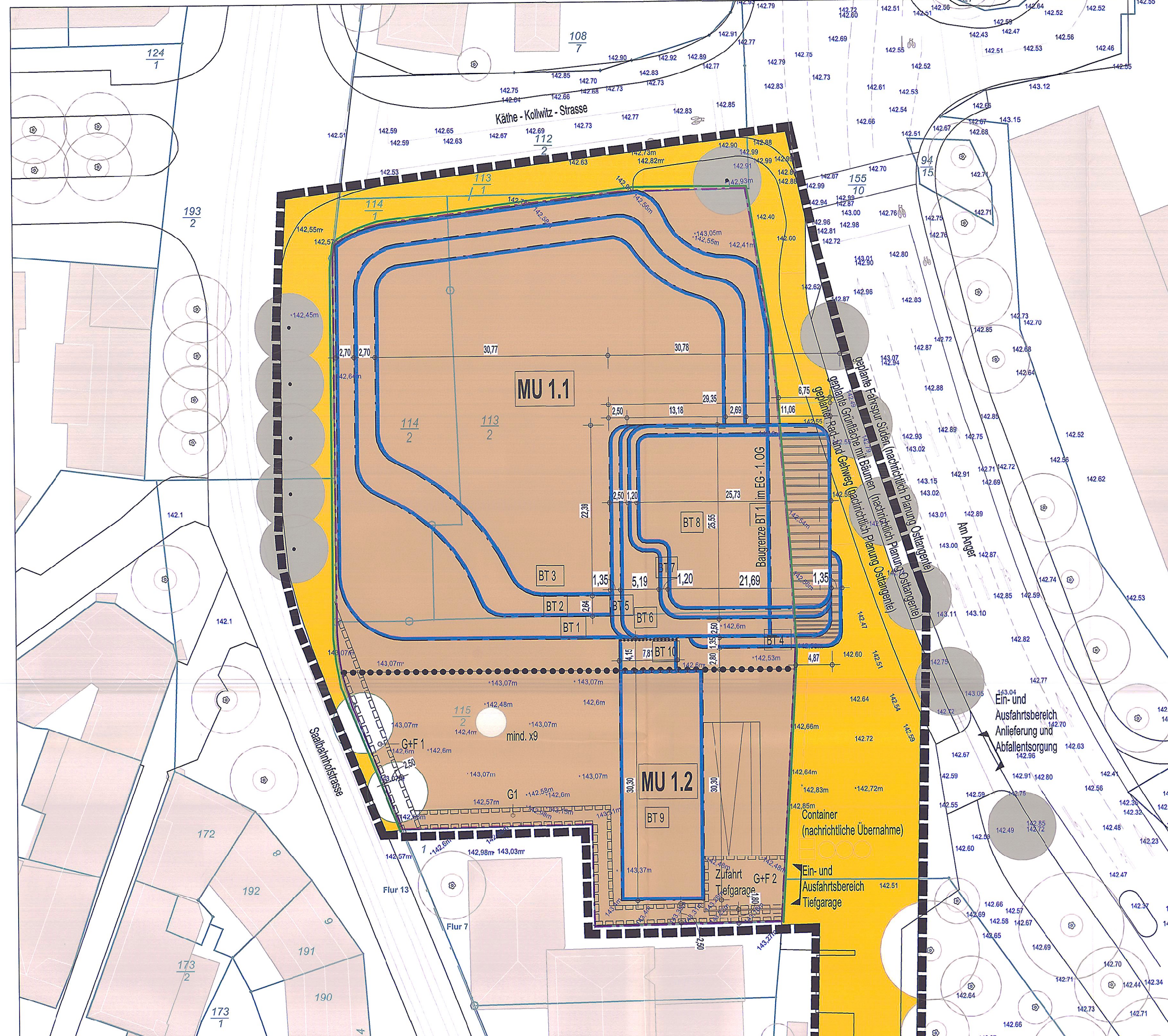
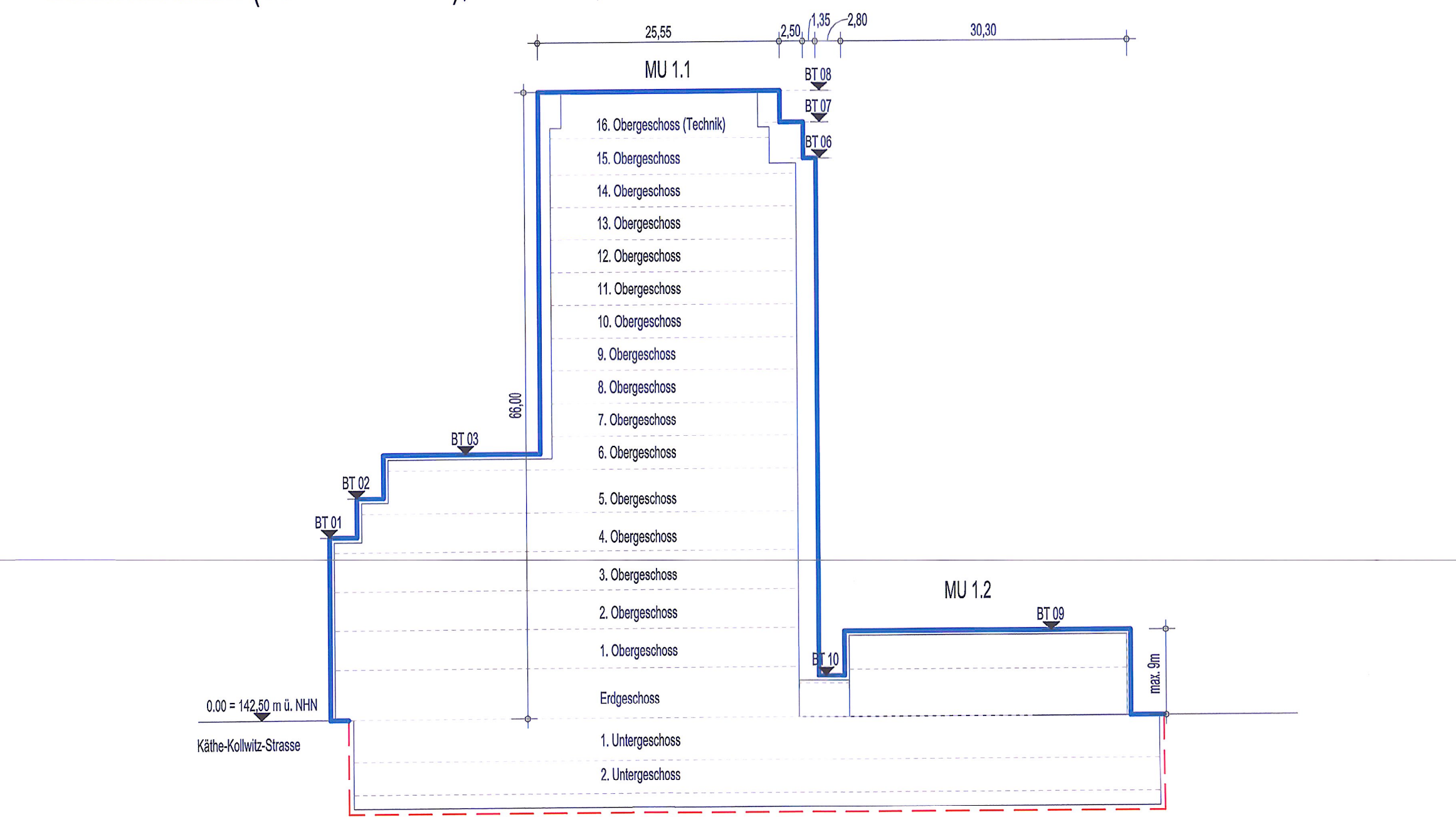

Table with 2 columns: Grundflächenzahl and Geschosshöhe. It lists floor area ratios for different building parts and maximum floor heights for various levels (BT 1 to BT 10).



Schemaskizzen (Vertikalschnitte), M= 1:500, Hinweisfunktion



Teilbaugebiete MU 1.1 und MU 1.2, Sicht von Westen



Planzeichnung Tiefgarage M= 1:500

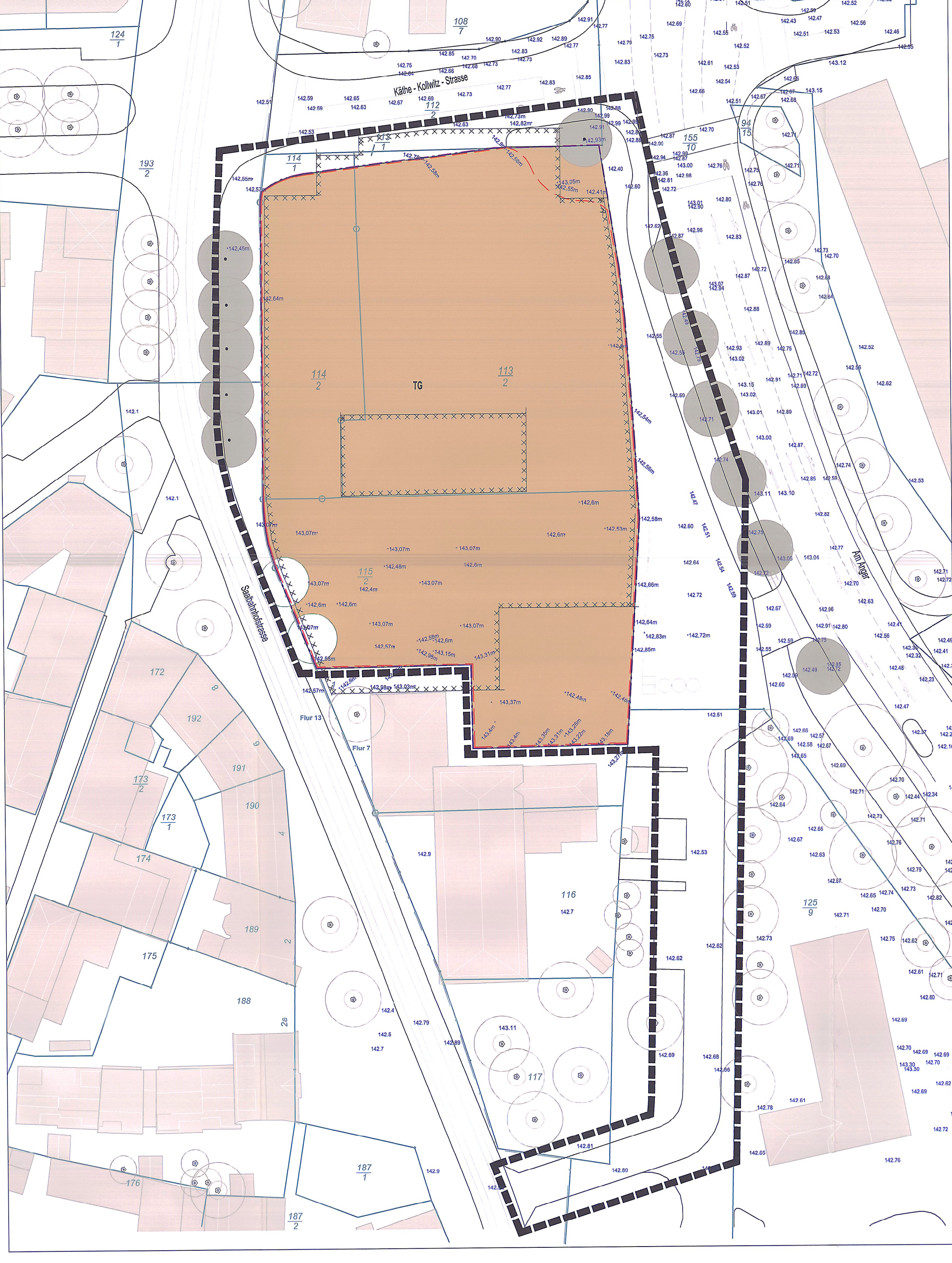

Teilbaugebiet MU 1.1, Sicht von Süden



Comprehensive text block containing regulations, technical specifications, and project details. It includes sections on building height, parking, accessibility, and specific construction requirements for the building and garage.

Administrative and legal information including approval stamps, dates, and contact details for the project team and the city of Jena.